

USER MANUAL

WARNINGS

1. Tempered glass with film protector is used on the front surface of this luminaire. Please protect it from impacts during installation. Damaged glass must be replaced by an authorized service center.
2. LED Light sources are extremely bright. Do not look directly into the LED beam to avoid damage to the eyes.
3. The light source in this luminaire must only be replaced by the manufacturer or its service agent or a similarly qualified person.
4. There are no parts inside the product that you can repair, do not open the inside of the product.
5. During use, avoid touching any external surface of the luminaire due to high heat dissipation.
6. In the event of damage to the external flexible cable or cord of this luminaire, it must be replaced only by the manufacturer or its authorized service or equivalent qualified personnel to prevent a hazard.
7. Luminaire cannot be mounted on flammable surfaces Luminaire should not be mounted closer than 1 meter to flammable objects.
8. This luminaire is suitable for use at ambient temperatures between -20°C and +50°C.
9. This luminaire is suitable for indoor and outdoor use and is not suitable for environments with explosive and corrosive gases.
10. The luminaire should not be mounted on surfaces that will prevent natural air circulation or be covered. In order to prevent overheating that may occur during use, care should be taken to ensure that there is sufficient air space between the luminaire body and the surrounding objects.
11. Disconnect the power before starting installation. The supply voltage of the luminaire is 230V AC 50-60Hz and the product must be connected to the ground line and a fuse and residual current relay of appropriate value must be installed on the line.
12. Inappropriate voltage or connection type, high pulse energy discharges (such as lightning), mains power surges, unauthorized intervention to product components, modifications to the product will void the product warranty.
13. To prevent damage or abrasion to the cables, connect the cables away from metal conduit edges or sharp corners.
14. Do not use solvent solvent chemicals for cleaning the armature, clean with warm soapy water. Paper dust and textile threads accumulated on the armature should be cleaned with air at regular intervals.
15. It is the responsibility of the installer to ensure that the supply cable supplied with the luminaire and the field cable joint point are watertight and connected correctly. For outdoor use, the cable connection points must be insulated with melting tape.

Markings :



Hand tools to be used :

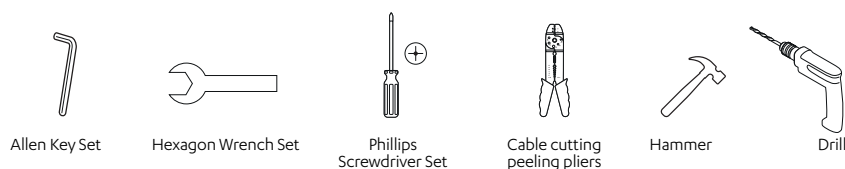

ASSEMBLY INSTRUCTIONS

1

Place the ceiling bracket on the surface and mark the hole location.



2

Drill the marked place with a drill and hammer the 8mm dowel into the hole with a hammer. Align the apparatus on the dowel and screw it with a Phillips screw.

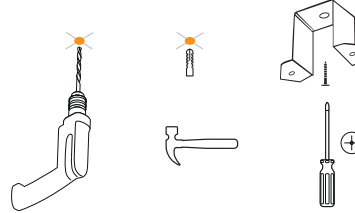

3

Screw by aligning the screws in the ear holes of the apparatus to the screw nuts on the case.

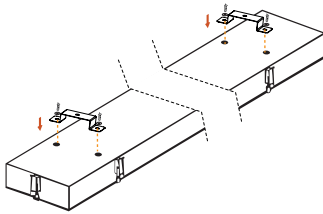

4

Screw by aligning the screw places in the apparatus ear holes to the screw nuts on the case.

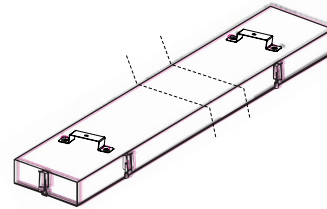

5

For Ceiling Mounting, Fix the Apparatus by Using M8 Bolts and Nuts

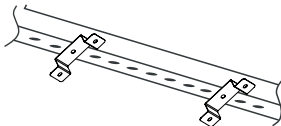

6

For Busbar Installation, pass the C suspension apparatus included in the box through the Busbar and Omega apparatus and release the luminaire.

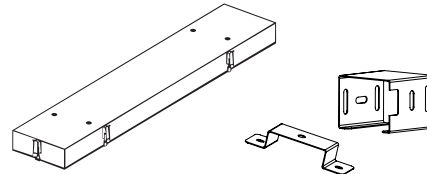

7

Connect the cable coming from the field and the armature supply cable with the appropriate junction box and terminal block so that it does not get water and energize the armature.

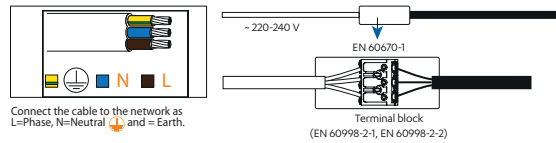

TECHNICAL SPECIFICATIONS

Item Code	Power (W)	Luminaire Lumen (lm)	Color Temperature (K)	Efficiency (lm/W)	Dimensions (LxWxH)	Qty/Carton	Carton Size (LxWxH)	G.W/Carton
LYT10.050	50W	6.000	3000/4000/6500	120lm/W	1200x150x100mm	3	1300x280x210mm	16.2 kg
LYT10.075	75W	9.000	3000/4000/6500	120lm/W	1200x150x100mm	3	1300x280x210mm	16.2 kg
LYT10.100	100W	12.000	3000/4000/6500	120lm/W	1200x150x100mm	3	1300x280x210mm	18 kg
LYT10.100	100W	12.000	3000/4000/6500	120lm/W	1200x210x100mm	3	1300x300x275mm	21.5 kg
LYT10.150	150W	18.000	3000/4000/6500	120lm/W	1200x210x100mm	3	1300x300x275mm	21.5 kg