



LED BAR

AREAS OF APPLICATION

Shops • Cafes • Restaurants • Offices • Training Halls • Hospitals
Suitable for use in the areas requiring decorative and high lumen lighting.



LED BAR IP65

LED BATTEN LIGHT



PRODUCT SPECIFICATIONS

- Body** : PC Body / PC Cover
- Optic Cover** : Opal PC Difuser
- Led Chip** : Osram-Samsung-Seoul
- Input Voltage** : 220-240V/AC 50-60Hz
- Temperature Range** : -20°C~+40°C
- CRI** : CRI > 80
- IP Class** : IP65
- Options** : Color Temperature: 3200K/4000K/6500K
Red/Green/Blue/Amber/Meat
Including magnet that sticks on metal perfectly.
Optional Magnetic Led Bar Light

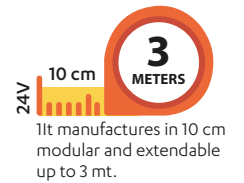
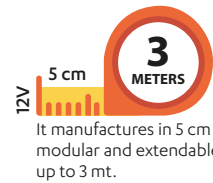

PHOTOMETRIC DISTRIBUTION

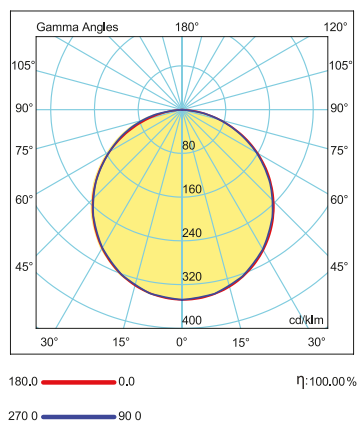

TECHNICAL DRAWING

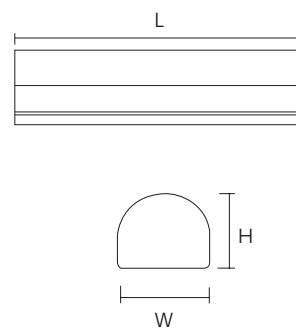

FIXTURE ACCESSORIES



PRODUCT SPECIFICATIONS

Item Code	Power (W)	Luminaire Lumen (lm)	Color Temperature (K)	Efficiency (lm/W)	Dimensions (LxWxH)	Qty/Carton	Carton Size (LxWxH)	G.W/Carton
LLN12.014	14W	1.050	3000/4000/6500	75lm/W	1000x22x18mm	-	-	-

*3N Company has the right to make any changes it deems necessary without prior notice.
*Technical data has a tolerance of ± 10%.